

CONCRETE SPECIFICATIONS

COMPRESSIVE STRENGTH @ 28 DAYS -- 4000 PSI
MINIMUM CEMENT CONTENT -- 6 SACKS/YARD
MAXIMUM SLUMP -- 4" +/- 1"

TOWER DRYER MODEL 24100

-17'-6" DIA PAD, 9" THICK WITH THE OUTER
57" A TOTAL OF 48" THICK.

-31 CU. YD. CONCRETE.

-#4 REINF. RODS ON 1'-0" CENTERS
BOTH DIRECTIONS IN SLAB AND BOTTOM
OF FOOTING.

-840' #4 REBAR.

8 DRYER LEGS

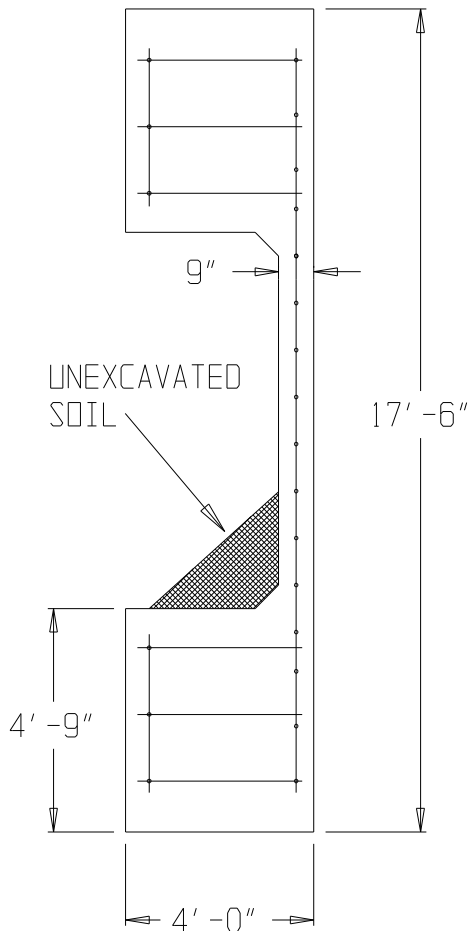

1' X 1' REINF. ROD
MAT IN PAD

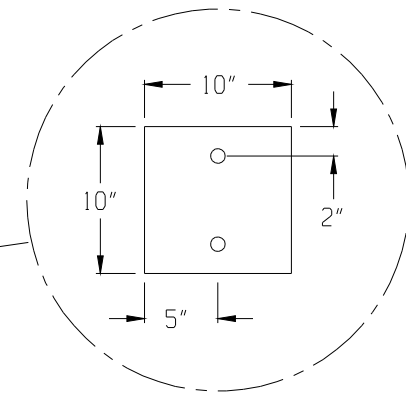
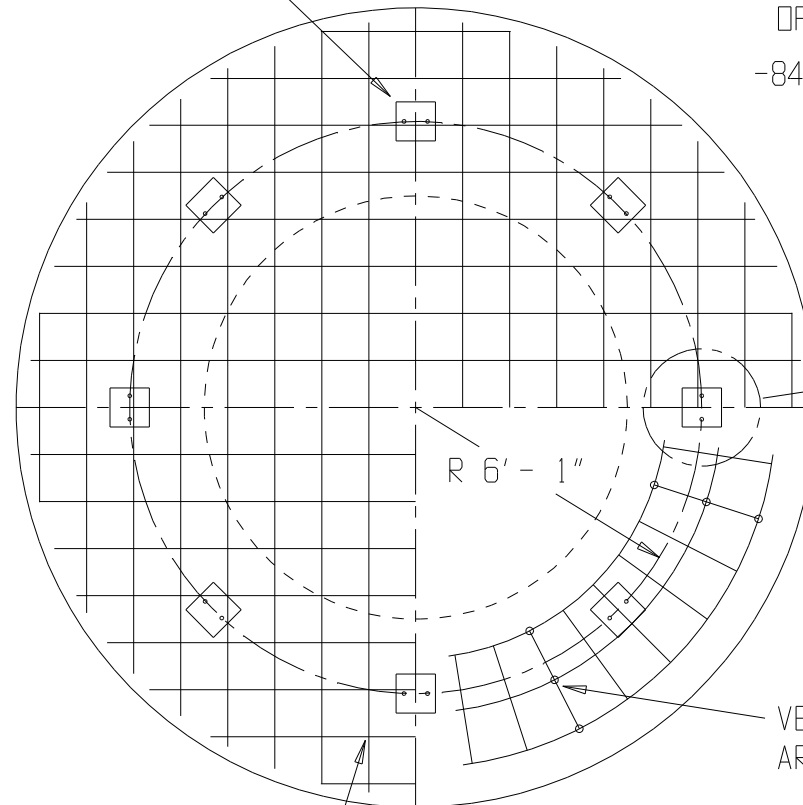

DRYER LEG BASE PLATE DETAIL

-ANCHOR DRYER USING 1" X 12"
(MINIMUM) EPOXY ANCHORS.

VERTICAL REINF. BARS 5'-0" O.C.
AROUND FOOTING

NOTES:

1. FOUNDATION DESIGN BASED ON NET
SOIL BEARING PRESSURE OF 3000 PSF.
2. SITE SHALL BE FREE OF ANY DEBRIS
OR VEGETATION AND WELL DRAINED.
3. ALL REINFORCING STEEL TO BE A-615
GRADE 40 DEFORMED BARS.

No.	ECN	Revision Description	Date	By



GRAIN SYSTEMS
INCORPORATED
Assumption, IL. 62510 217/226-4421

FOUNDATION PLAN

NORTHERN & CENTRAL UNITED STATES

TOLERANCES
(Unless Noted)
Fractions +/- 1/32"
Decimals +/- .031"
Angles +/-

Quantity			Material	
Sq. Ft.	Blk. Wt.	Ship Wt.	Drawing No.	