

DUMP HOPPERS

Bolt an angle dam to each top chute using (3) 1/4" x 3/4" bolts and nuts. Bolt a chute deflector to the front of the hopper using (3) #10 - 24 x 1/2" bolts (heads inside the hopper) and nuts. Use 1/4" x 3/4" bolts and double nuts to fasten top chute to hopper, as shown below in detail A. Use 1/4" x 3/4" bolts and single nuts to fasten top chute to bottom chute, chute straps to top and bottom chutes, and end diverter to bottom chute as shown below in detail B. Using 1/4" x 3/4" bolts and nuts install the top and bottom cover plates over the chutes.

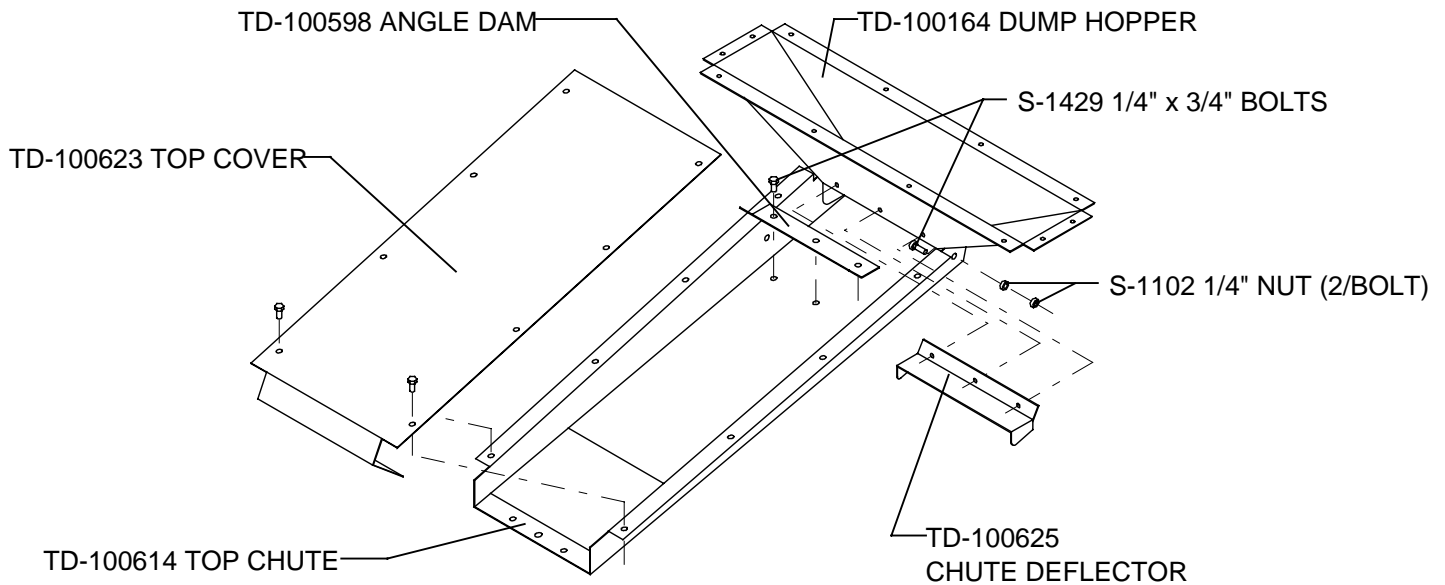

DETAIL A

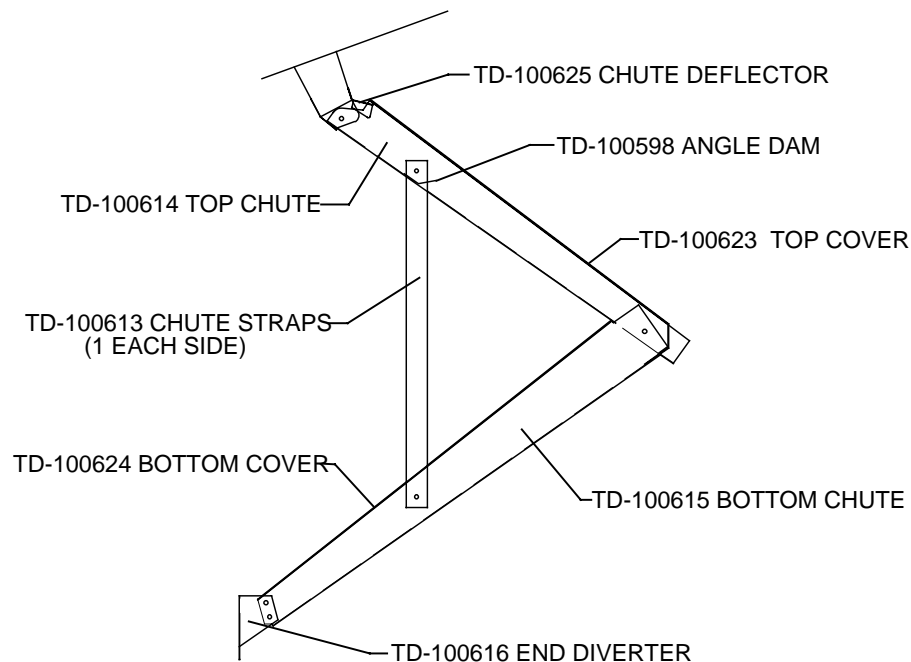

DETAIL B