

Wire Grill Guard Roof Vent Assembly & Installation Instructions

The following instructions are for assembling and installing the Wire Grill Guard Roof Vent. First, check the packing list to ensure all components have been shipped. The unit is easiest assembled in the **upside down position** as shown in the instructions. Roof vent location should be as shown on the reverse page.

ASSEMBLY

1. Take all parts out of the shipping box and check if all parts are present.
2. Turn one (1) roof vent housing (MIS-6778) upside down. (See Figure #1)
3. Insert 5/16" x 1.1/4" bin bolt with neoprene washer through hole in the side of the roof vent. Place jamb nut onto the bolt and tighten. (See Figure #1).
4. Slide on eyelet of Grill Guard onto the 5/16" bin bolt.
5. Insert 5/16" x 1.1/4" bin bolt with neoprene washer through the other side of the roof vent, through jamb nut and other eyelet of Grill Guard. Tighten nut against vent housing side.)
6. Apply a bead of tube caulking around three(3) housing sides of the roof vent where it meets the holddown angle.
7. Place holddown angle (MIS-4404) on the assembled roof vent. The wide end of the hole-down angle must face vent discharge. Once aligned, screw nine (9) #10 self drilling (S-280) screws through the roof housing and into the holddown angle. (See Figure #2).

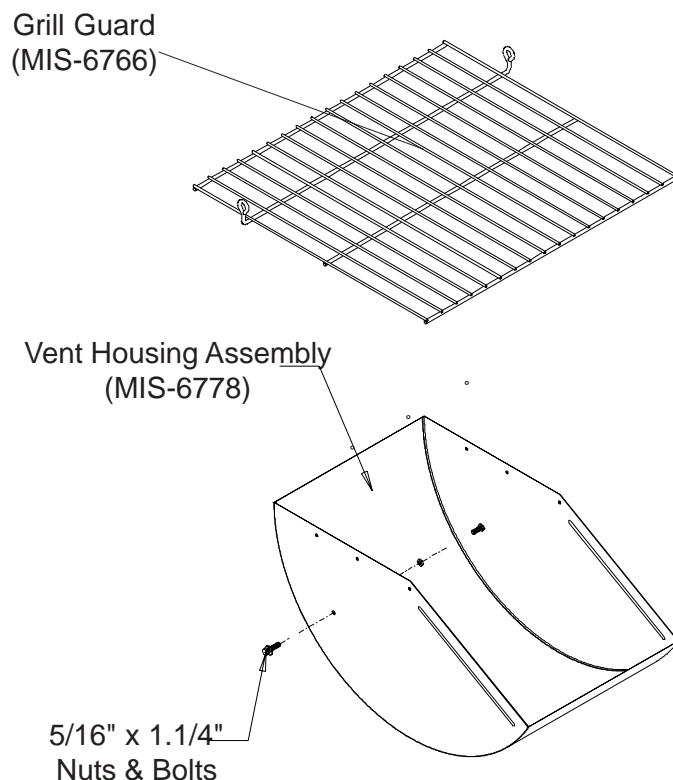

Figure #1

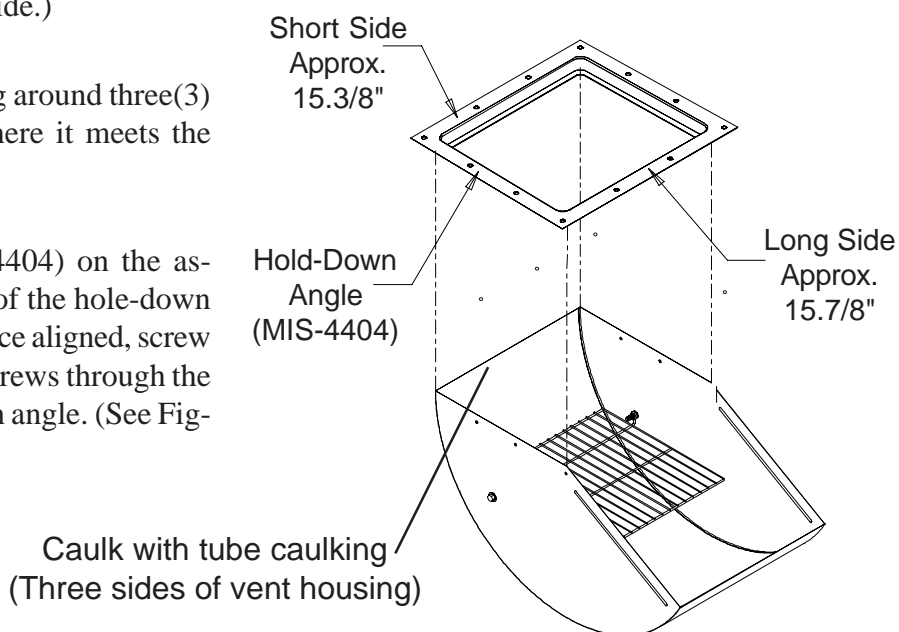

Figure #2

Wire Grill Guard Roof Vent Installation

Installation

8. If the roof sheet does not have a prepunched hole for the roof vent, a hole must be cut. The cut hole should match the roof vent. The hole inside edge should be approximately fifteen (15) inches from the eave. (See Figure #5)

9. Place the three (3) foam strips on roof sheet, as shown in Figure #4. Position roof vent over foam strips and bolt down using 5/16" x 3/4" bin bolts and nuts. (Note: See instructions below for lower two (2) bolts of vent).

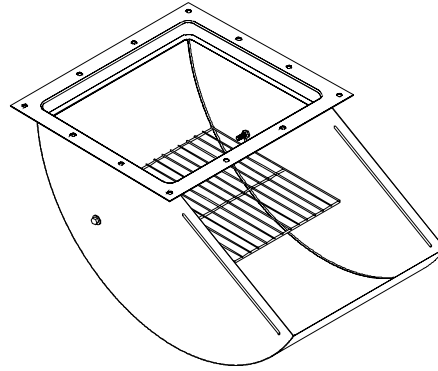

Figure #3

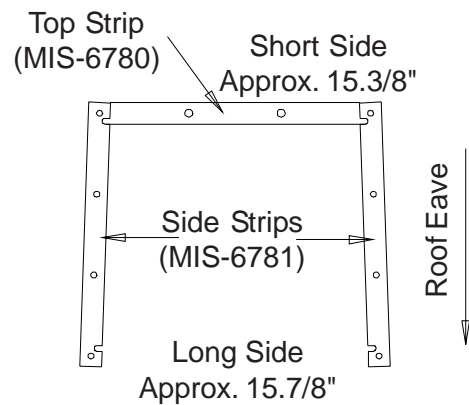
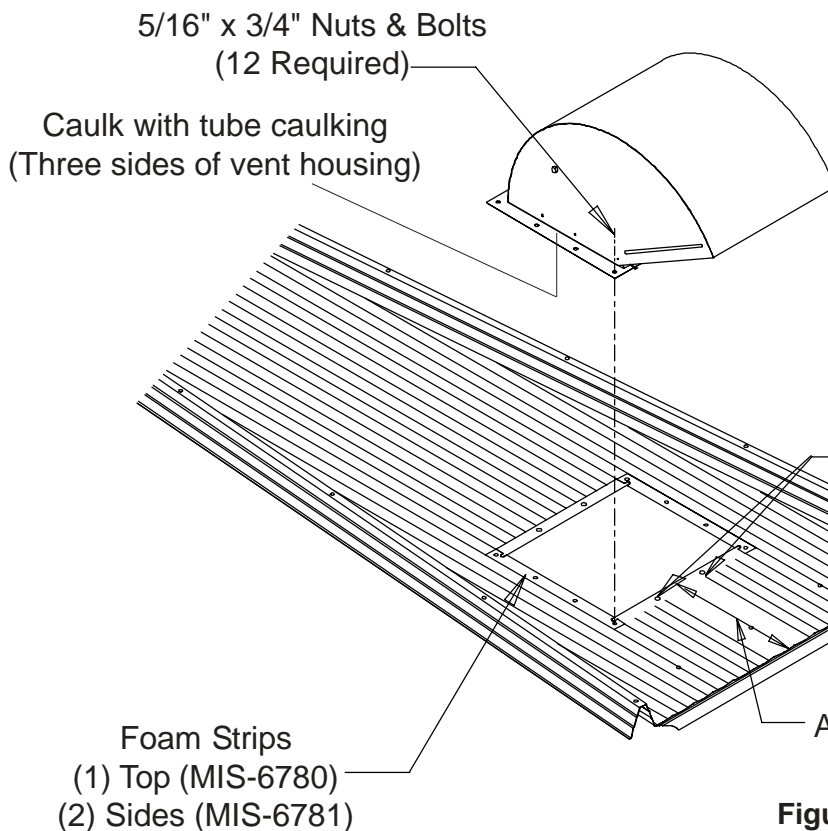

Figure #4



NOTE: Install bolts for these two (2) holes with the bolt head and neoprene washer to the underneath side of the roof sheet and the nut against the vent holddown angle. Caulk holes.

Figure #5