

Large Double Inlet Transition For 17" Floor

TR-6853

Bin Preparation

1. Field cut a hole in the bottom ring of your bin to 100" x 15 1/4". The base angle ring must also be removed from this area.

2. Mastic sealer is to be used on all bolt together seams. Use 5/16" x 1 1/4" (S-277) bolts to bolt entrance collar mounting bracket (#7) to bin. For all other bolt up use 5/16" x 3/4" bolts.

Entrance Collar Assembly

1. Bolt together all right hand and left hand parts, i.e. entrance collar top, right hand (#2) to left hand (#3).

2. Bolt the entrance collar braces (#8) and the entrance collar sides (#6) to the entrance collar bottom (#4 & #5) as shown.

3. Put in place the entrance collar top (#2 & #3) as shown. **NOTE: Do not bolt up holes on the fan side of the collar until the transition top panel is installed.**

4. Bolt the entrance collar mounting bracket (#7) to the entrance collar side (#6).

Slide the entrance collar assembly into the cut-out in the bin. Field drill 8 holes in the bin for the entrance collar mounting bracket. Bolt up the entrance collar mounting bracket to the bin. If there is a gap between the entrance collar top and the cut-out in the bin; place shims above each brace (#8).

5. Field drill holes in the sizing angles (#1) and the entrance collar top (#2 & #3) and use self-tapper screws (S-7621).

Final Assembly

1. Place the flange of the bottom panels (#13 & #14) into the groove of the entrance collar bottom (#4 & #5).

2. Bolt transition side panels (#11 & #12) to bottom panels (#13 & #14) and to entrance collar sides (#6) as shown.

3. Bolt transition top panels (#9 & #10) to the transition side panels (#11 & #12) and to the entrance collar top (#2 & #3) as shown.

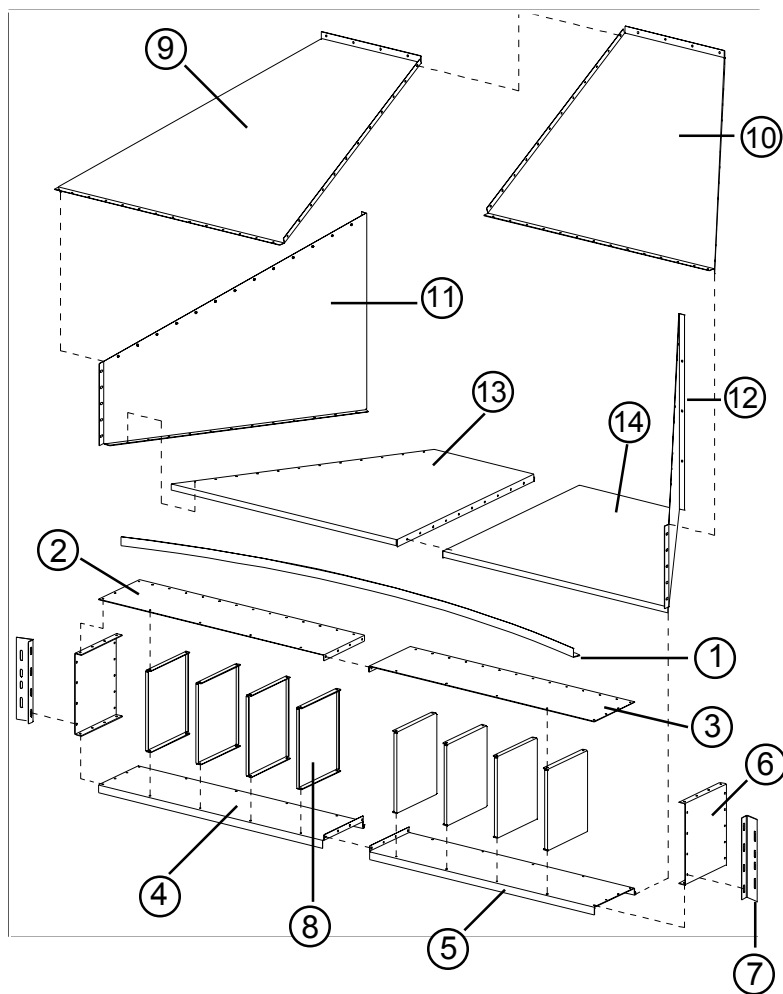

Figure 1: Transition for double inlet centrifugal fans

Large Double Inlet Transition For 17" Floor

TR-6853 Parts List

Item #	Part #	Description	Quantity
1	TR-6194	Sizing Angle	2
2	TR-7004	Entrance Collar Top, Right Hand	1
3	TR-7005	Entrance Collar Top, Left Hand	1
4	TR-7006	Entrance Collar Bottom, Right Hand	1
5	TR-7007	Entrance Collar Bottom, Left Hand	1
6	TR-7003	Entrance Collar Side	2
7	TR-7009	Entrance Collar Mounting Bracket	2
8	TR-7008	Entrance Collar Brace	8
9	TR-7001	Transition Top Panel, Right Hand	1
10	TR-7002	Transition Top Panel, Left Hand	1
11	TR-6999	Transition Side Panel, Right Hand	1
12	TR-7000	Transition Side Panel, Left Hand	1
13	TR-6997	Transition Bottom Panel, Right Hand	1
14	TR-6998	Transition Bottom Panel, Left Hand	1
NS	S-275	5/16" x 3/4" Bin Bolt	185
NS	S-396	5/16-18 Hex Nut	195
NS	S-4485	Mastic Sealer	4
NS	S-7261	Screw #10-16 x 1" Self-Drilling	46
NS	S-277	Bolt 5/16" -18 1-1/4" Bin Bolt	10