

PNEG-130

INSTALLATION INSTRUCTIONS

1. Be sure and use caulking that is provided on all seams and corners throughout the assembly.
2. Bottom Panel flanges should always be on the “outside” of the Transition Assembly. Refer to Bottom Panel Flange Detail for proper flange direction and assembly of individual flange type. Bolt bottom panel to all entrance collar braces and side entrance collar pieces. Be sure and use 5/16” x 3/4” bolts and nuts.
3. Install and bolt top entrance collar to entrance collar braces and side pieces. Bolt transition sides to bottom panel. After sides are complete bolt top panel into position. Be sure and use 5/16” x 3/4” bolts and nuts on all pieces.
4. Field cut hole in bin sidewall 68 1/4” x 11 3/4” to allow transition to fit properly.
5. Install entrance collar mounting brackets to transition on inside of bin. Be sure and use 5/16” x 3/4” bolts and nuts.
6. Using 5/16” x 1 1/4” bolts and nuts, install entrance collar mounting brackets to bin sidewall. Installer must seal between bin sidewall and entrance collar mounting brackets. No sealer is provided.
7. After putting transition on bin, locate sizing angle to curvature of bin, screw to top entrance collar and to bin sidewall. Use #10 x 1” screws.

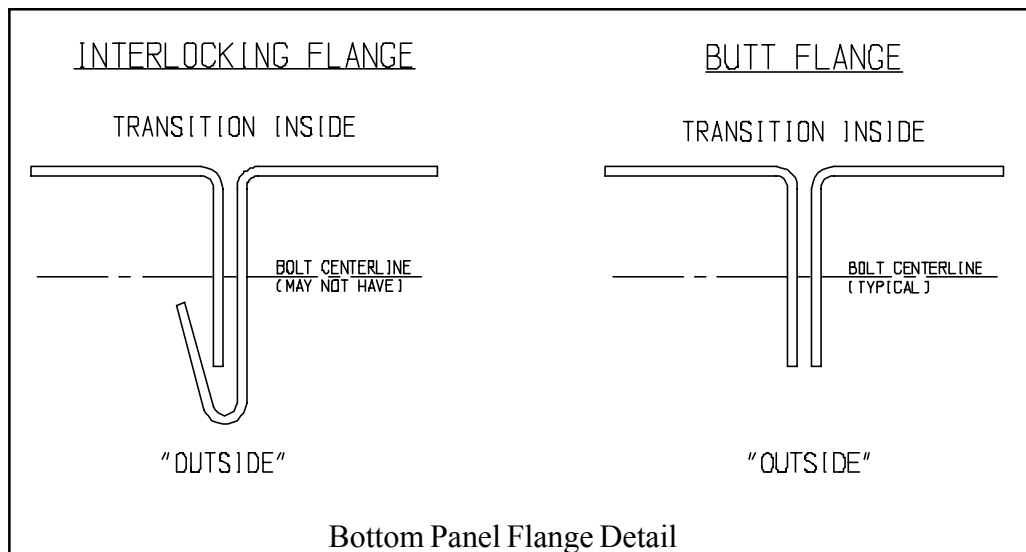

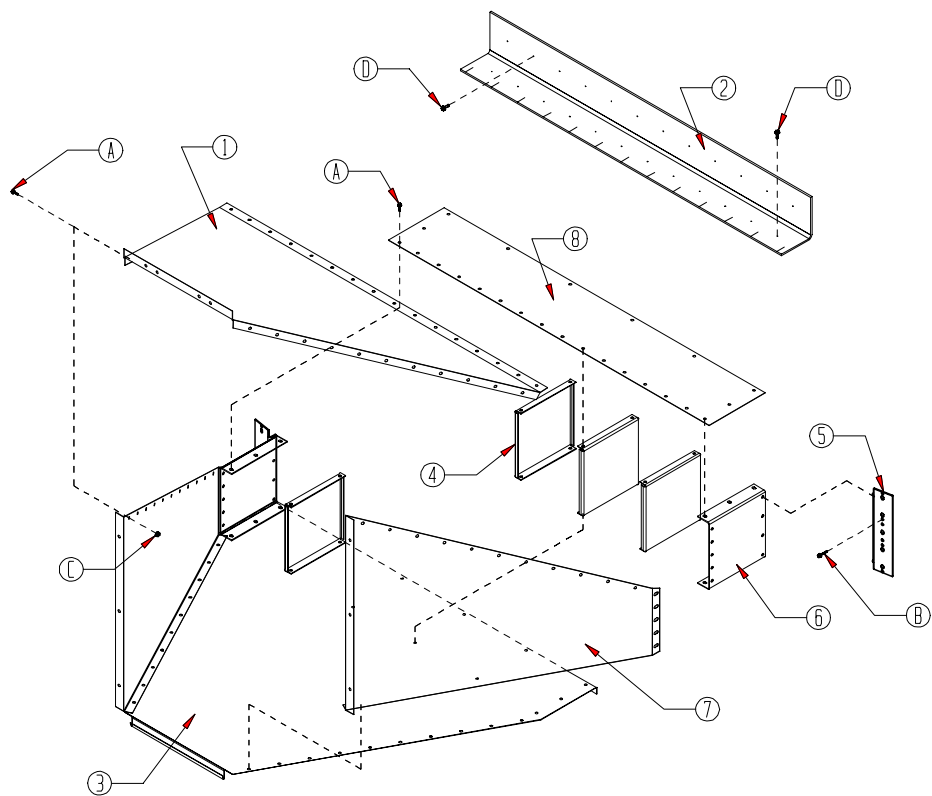

| Trans number | Key | Quantity | Part Number | Description |
|--------------|-----------------|----------|-------------|----------------------------------|
| TR-6207 | Parts Inventory | | | |
| | 8 | 1 | TR-6192 | Top Entrance Collar |
| | 2 | 1 | TR-6194 | Sizing Angle |
| | 6 | 2 | TR-6196 | Side Entrance Collar |
| | 7 | 1 | TR-6203-1 | Righthand Side Panel |
| | 7 | 1 | TR-6203-2 | Lefthand Side Panel |
| | 1 | 1 | TR-6205 | Top Panel |
| | 3 | 1 | TR-6206 | Bottom Panel |
| | 4 | 4 | TR-6312 | Entrance Collar Brace |
| | 5 | 2 | TR-6476 | Entrance Collar Mounting Bracket |
| | | 1 | PL-6208 | Hardware Package |
| PL-6208 | Parts Inventory | | | |
| | A | 113 | S-275 | 5/16"-18 x 3/4" Bin bolt |
| | B | 10 | S-277 | 5/16"-18 x 1 1/4" Bin bolt |
| | C | 123 | S-396 | 5/16"-18 Hex nut |
| | D | 30 | S-7621 | #10-16 x 1" selfdrilling screw |