

**PNEG-1334  
11-5-03**

# **E-Z GLIDE**

## **10" & 12" Swing Away Hydraulic Hopper Wheel Kit**

**PNEG-1334  
11-5-03**

# **E-Z GLIDE**

## **10" & 12" Swing Away Hydraulic Hopper Wheel Kit**

Assembly Manual

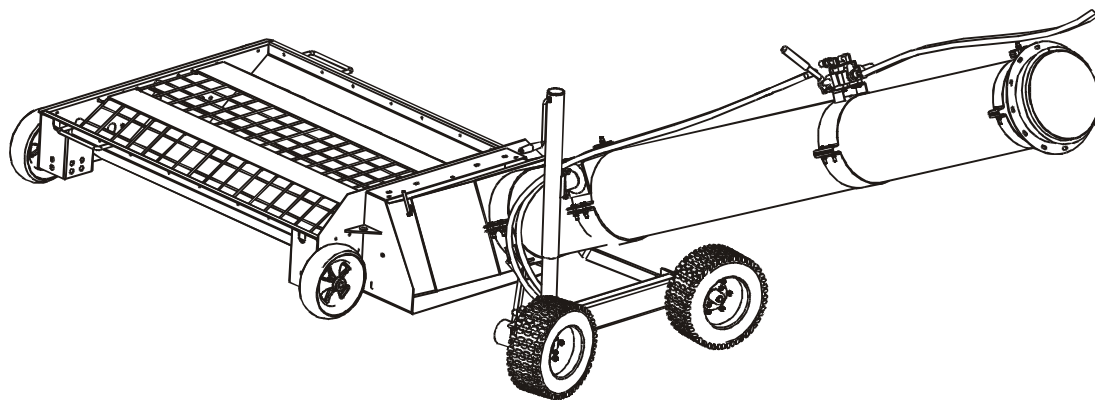

PNEG-1334



## SAFETY GUIDELINES

This manual contains information that is important for you, the owner/operator, to know and understand. This information relates to protecting **personal safety** and **preventing equipment problems**. It is the responsibility of the owner/operator to inform anyone operating or working in the area of this equipment of these safety guidelines. To help you recognize this information, we use the symbols that are defined below.

Please read the manual and pay attention to these sections. Failure to read this manual and it's safety instructions is a misuse of the equipment and may lead to serious injury or death.

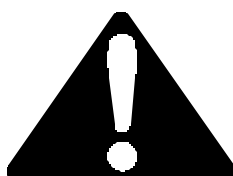

**This is the safety alert symbol. It is used to alert you to potential personal injury hazards. Obey all safety messages that follow this symbol to avoid possible injury or death.**



**DANGER** indicates an imminently hazardous situation which, if not avoided, will result in death or serious injury.



**WARNING** indicates a potentially hazardous situation which, if not avoided, could result in death or serious injury.



**CAUTION** indicates a potentially hazardous situation which, if not avoided, may result in minor or moderate injury.

**CAUTION**

**CAUTION** used without the safety alert symbol indicates a potentially hazardous situation which, if not avoided, may result in property damage.

**NOTE**

**NOTE** indicates information about the equipment that you should pay special attention to.

# Safety

## FOLLOW SAFETY INSTRUCTIONS

Carefully read all safety messages in this manual and on your machine safety signs. Keep signs in good condition. Replace missing or damaged safety signs. Be sure new equipment components and repair parts include the current safety signs. Replacement safety signs are available from the manufacturer.

Learn how to operate the machine and how to use controls properly. Do not let anyone operate without instruction.

Keep your machinery in proper working condition. Unauthorized modifications to the machine may impair the function and/or safety and affect machine life.

If you do not understand any part of this manual and need assistance, contact your dealer.

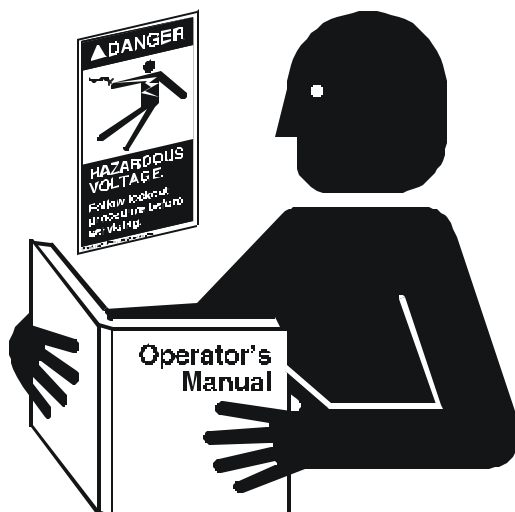

## AVOID HIGH-PRESSURE FLUIDS

Escaping fluid under pressure can penetrate the skin causing serious injury.

Avoid the hazard by relieving pressure before disconnecting hydraulic or other lines. Tighten all connections before applying pressure fluids.

If an accident occurs, see a doctor immediately. Any fluid injected into the skin must be surgically removed within a few hours or gangrene may result.



## INSTALL HYDRAULIC FLUID RESTRICTION ORIFICE

DO NOT OPERATE without Hydraulic Fluid Restriction Orifice installed.

Failure to install Orifice will make the Swing Out Hopper move very rapidly around auger and could crush you against the auger tube.

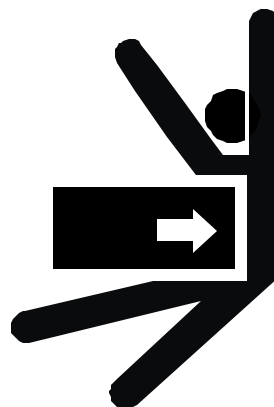

## PREPARE FOR EMERGENCIES

Be prepared if fire starts.

Keep a first aid kit and fire extinguisher handy.

Keep emergency numbers for doctors, ambulance service, hospital, and fire department near your telephone.

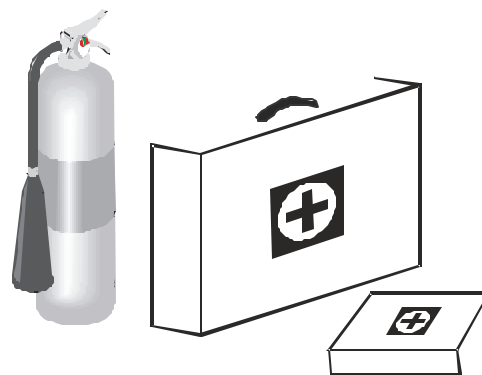

## WEAR PROTECTIVE CLOTHING

Wear close fitting clothing and safety equipment appropriate to the job.

Safety glasses should be worn at all times to protect eyes from debris.

Wear gloves to protect your hands from sharp edges on plastic or steel parts.

A respirator may be needed to help prevent breathing potentially toxic fumes and dust.

Wear hard hat and steel toe boots to help protect your head and toes from falling debris.

### Eye Protection

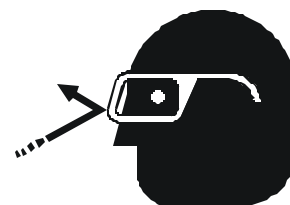

### Gloves



### Steel Toe Boots



### Respirator

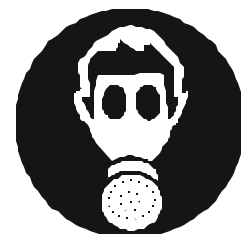

### Hard Hat



## Decal Locations

The safety decals shown below are included with the wheel kit. The decals should be located on the 4" Halfband under the Hydraulic control lever. Inspect all decals and replace any that are illegible, worn, or missing. Contact your dealer or the manufacturer to order free replacement decals.

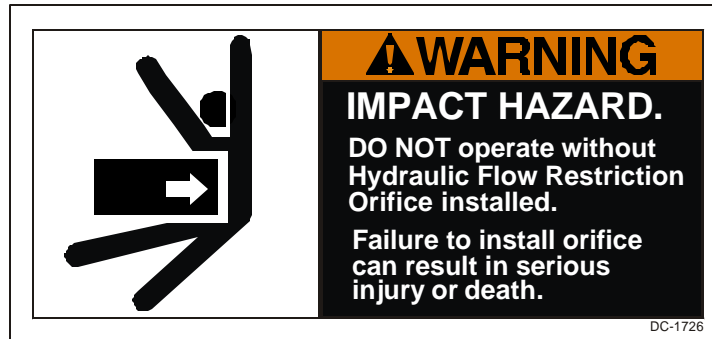

① DC-1726 (Size: 3-3/4" x 1-3/4")

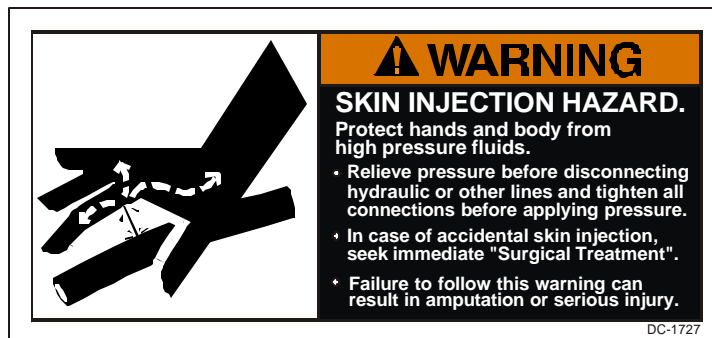

② DC-1727 (Size: 3-3/4" x 1-3/4")

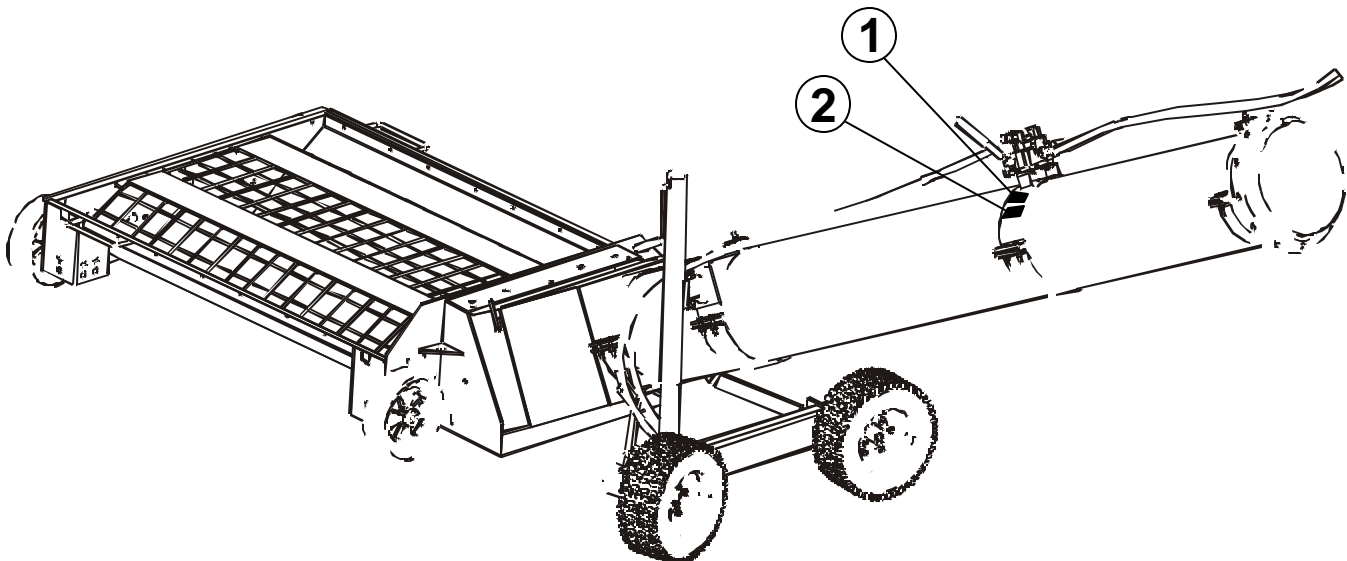

## Wheels to Axle

### 1. Assemble the Wheels to the axle.

- A. Bolt the hydraulic motor [1] to the axle [2] with (4) 3/8" x 3/4" hex bolts and lock nuts.
- B. Bolt the wheel [3] to the drive hub [4] with (4) 5/16" lock nuts.
- C. Slide the splined drive hub [4] over the hydraulic motor shaft then bolt it together with a 1/4" x 1-3/4" hex bolt.
- D. Attach the spindle [5] to the other end of the axle with (4) 3/8" x 1-1/4" hex bolts and lock nuts.
- E. Bolt the other hub [6] to the remaining wheel [3] with (4) 5/16" x 1" hex bolts and lock nuts.
- F. Slide the hub and wheel assembly onto the spindle [5] and fasten with the external snap ring [7].
- G. Attach the lower jack mount [8] to the axle [2] with (2) 3/8" x 3" hex bolts, flat washers, and lock nuts.

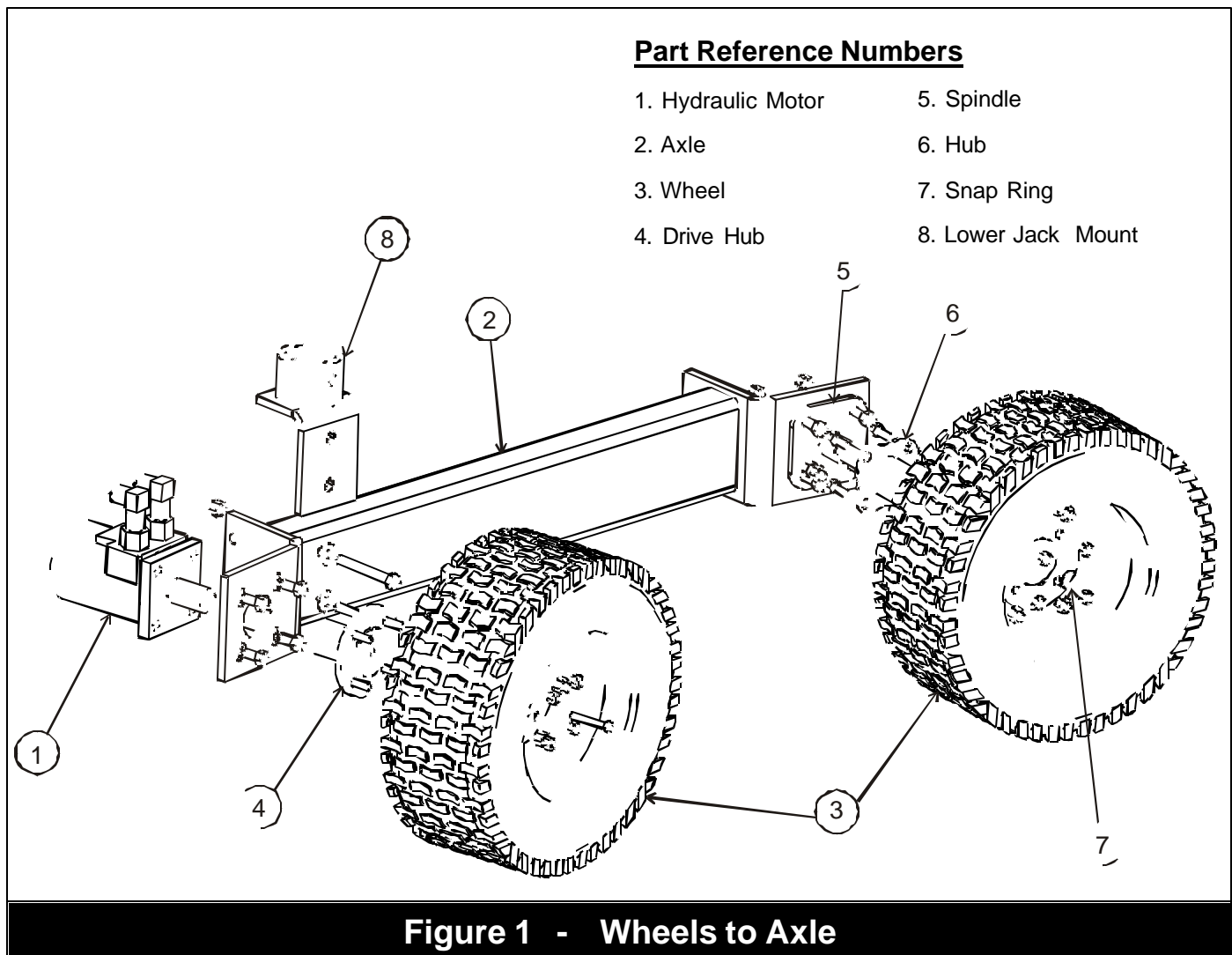

**Figure 1 - Wheels to Axle**

# Assembly

## Axle To Incline Tube

2. Connect axle assembly to the incline tube.

A. Attach a 4" wide connecting band [1] to the angle support half band [2] with (4)  $\frac{3}{8}$ " x  $1\frac{3}{4}$ " hex bolts and lock nuts. The half bands should be touching the incline hopper box weldment. (3)

B. Bolt the angled supports [4] to the brackets on the half band and the lower holes on the axle assembly [5] with (4)  $\frac{3}{8}$ " x  $1\frac{1}{4}$ " hex bolts and lock nuts. These points will need to pivot.

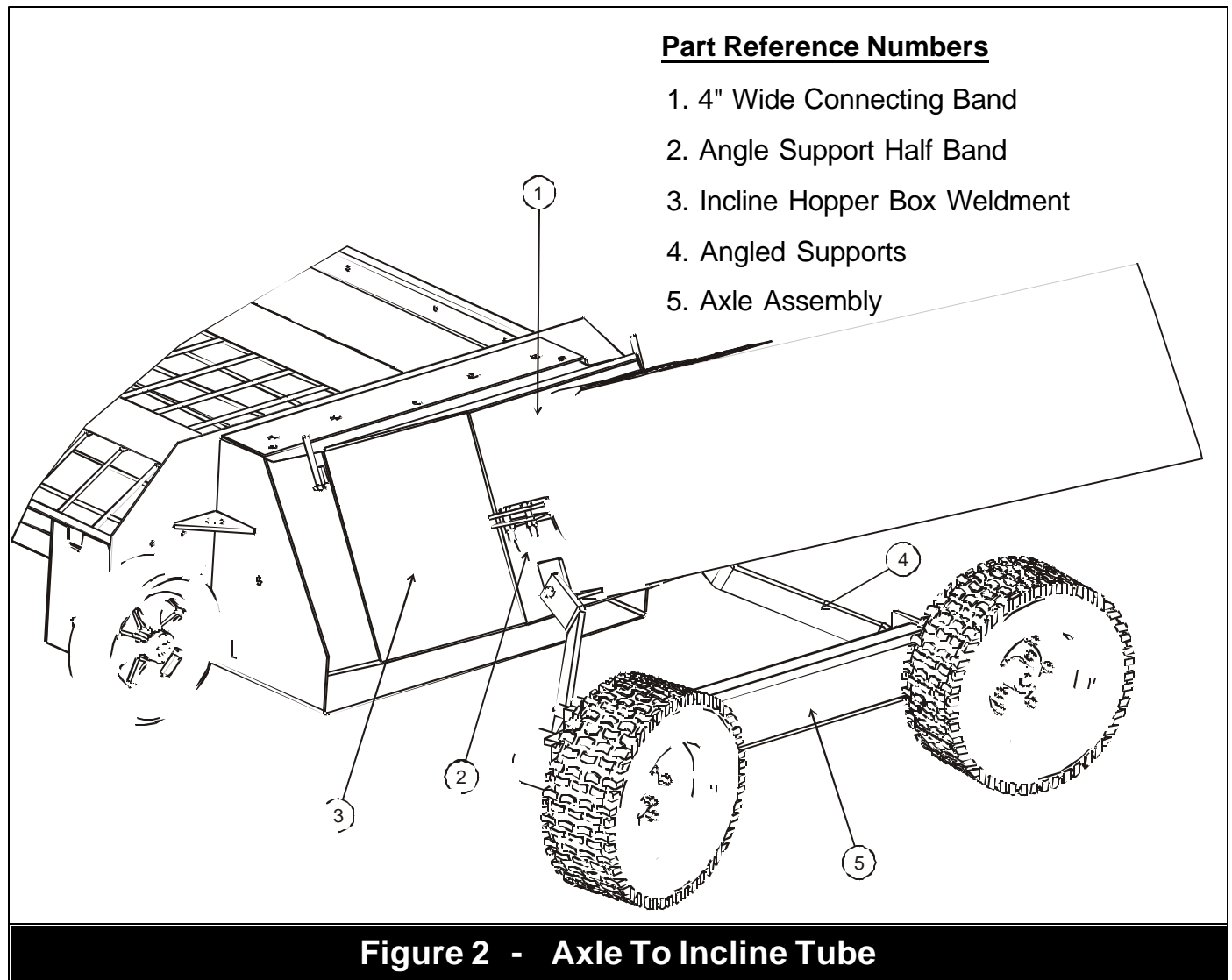



## Jack Assembly

### 3. Assemble the Jack.

- A. Bolt the jack to the lower jack mount [1] with a 3/8" x 3-1/2" hex bolt and lock nut.
- B. Place the jack pivot band [2] on the tube to the distance indicated.
- C. Bolt the jack to the jack pivot band [2] with a 5/8" x 3-1/2" hex bolt and lock nut.
- D. Attach the lower half band [3] with (4) 3/8" x 1-3/4" hex bolts and lock nuts.

#### Part Reference Numbers

- 1. Lower Jack Mount
- 2. Jack Pivot Band
- 3. Lower Half Band

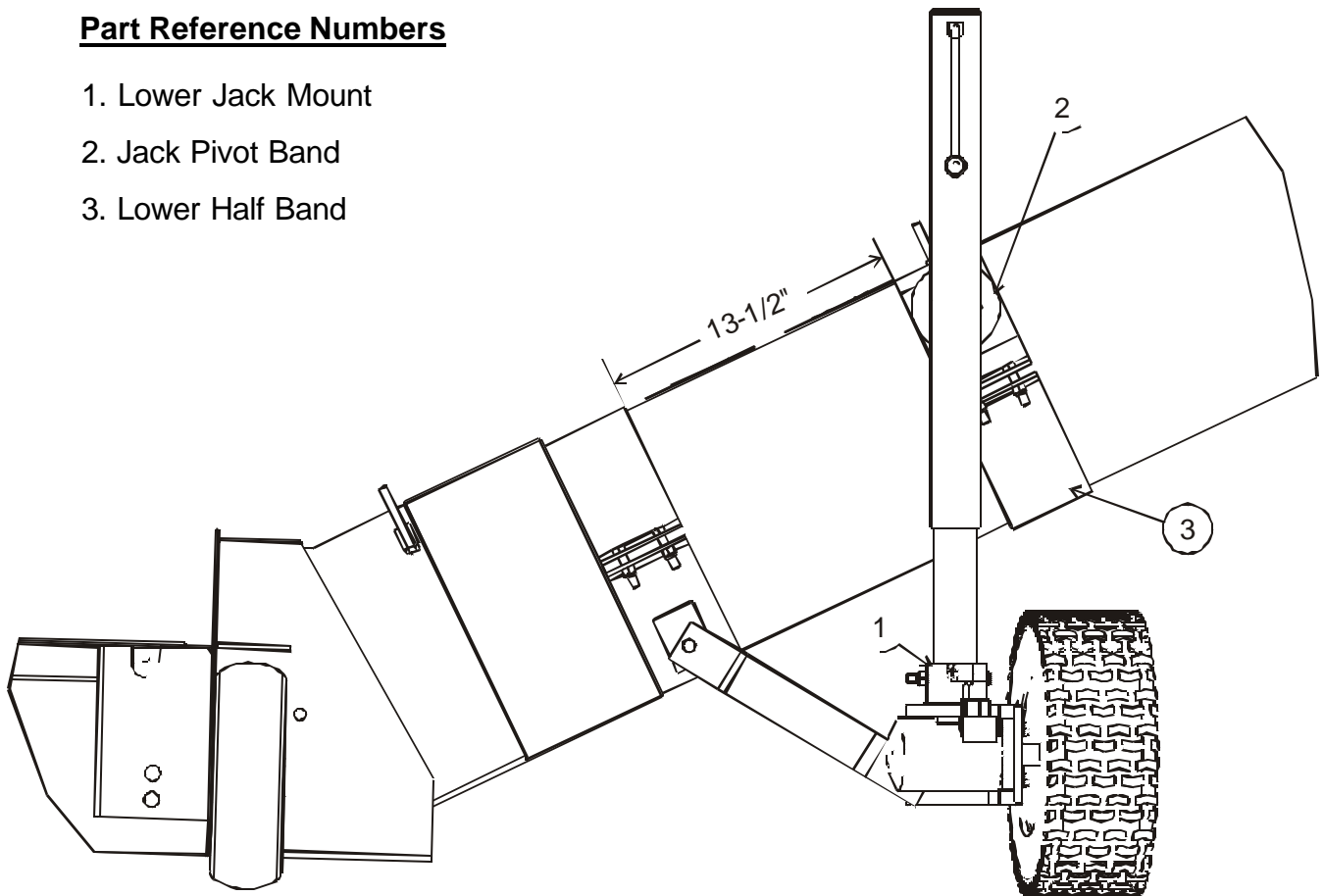

**Figure 3 - Jack Assembly**

## Directional Valve and Hydraulic Hoses

### 4. Assemble directional valve and hydraulic hoses.

- A. Connect the valve mount half band [1] to the tube with a 4" wide light gage band [2] and (4) 5/16" x 2" hex bolts and lock nuts.
- B. Bolt on the hose holder half band [3] with a 2" wide half band [4] and (2) 5/16" x 2" hex bolts and lock nuts.
- C. Attach the directional valve [5] to the valve mount half band with (4) 3/8" x 3/4" hex bolts.
- D. Connect the 84" (7') hydraulic hoses [6] by attaching the 1/2" NPT end to the hydraulic motor fittings [7].
- E. Assemble (2) 1/2" NPT 90° elbows [8] to the directional valve [5].
- F. Assemble the 1/2" NPT orifice [9] to one of the 90° fittings.
- G. Connect the remaining ends of the 84" (7') hydraulic hoses [6] to the 90° fitting and orifice [9].
- H. Assemble the 3/4" to 1/2" 90° elbow [10] to the intake end of the valve.
- I. Assemble the 3/4" to 1/2" fitting [11] to the other side of the valve.
- J. Connect the 168" (14') hydraulic hose [12] to the remaining 90° elbow and fitting on the directional valve.
- K. Bolt the hoses to the jack pivot band [13] and the upper hose holder band [14] with (4) hose holder brackets and 3/8" lock nuts.

#### **WARNING**

The 1/2" NPT orifice must be assembled in order to properly restrict the flow of hydraulic fluid through the motor.

#### **CAUTION**

The hopper may move quickly with some tractors. Be sure everyone is clear of the work area when using the mover.

#### **NOTE**

The directional valve is a four-way valve designed to operate a two-way hydraulic circuit from a single hydraulic source. The valve is also closed center, meaning all ports are blocked when the valve spring returns to neutral.

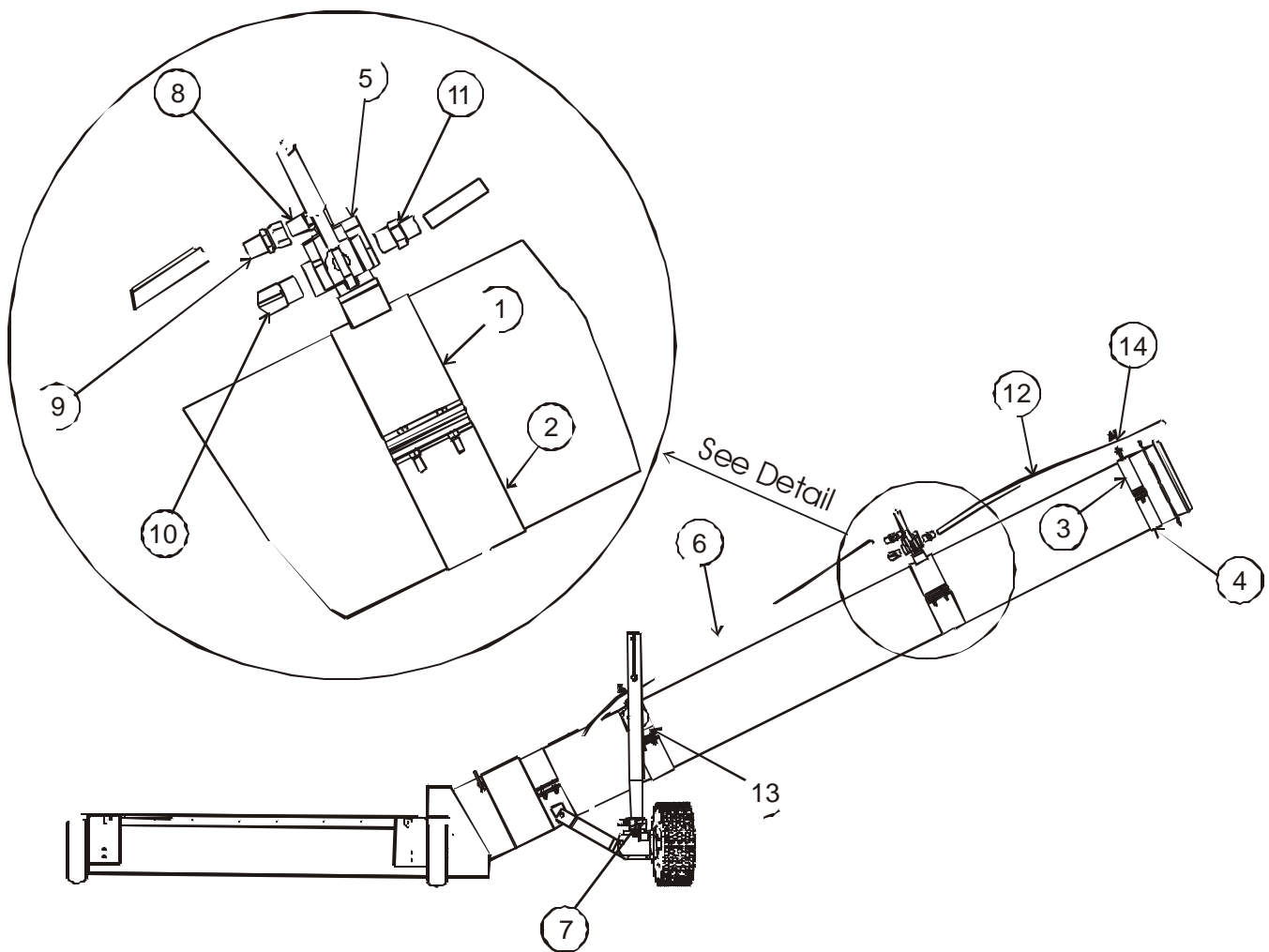

## Part Reference Numbers

- |                                 |                            |
|---------------------------------|----------------------------|
| 1. Value Mount Half Band        | 8. 1/2" NPT 90° Elbows     |
| 2. 4" Wide Light Gage Half Band | 9. 1/2" NPT Orifice        |
| 3. Hose Holder Half Band        | 10. 3/4" to 1/2" 90° Elbow |
| 4. 2" Wide Half Band            | 11. 3/4" to 1/2" Fitting   |
| 5. Directional Valve            | 12. 14' Hydraulic Hose     |
| 6. 7' Hydraulic Hose            | 13. Jack Pivot Band        |
| 7. Hydraulic Motor Fittings     | 14. Hose Holder            |

**Figure 4 - Directional Value and Hydraulic Hoses**

Axle & Jack Parts

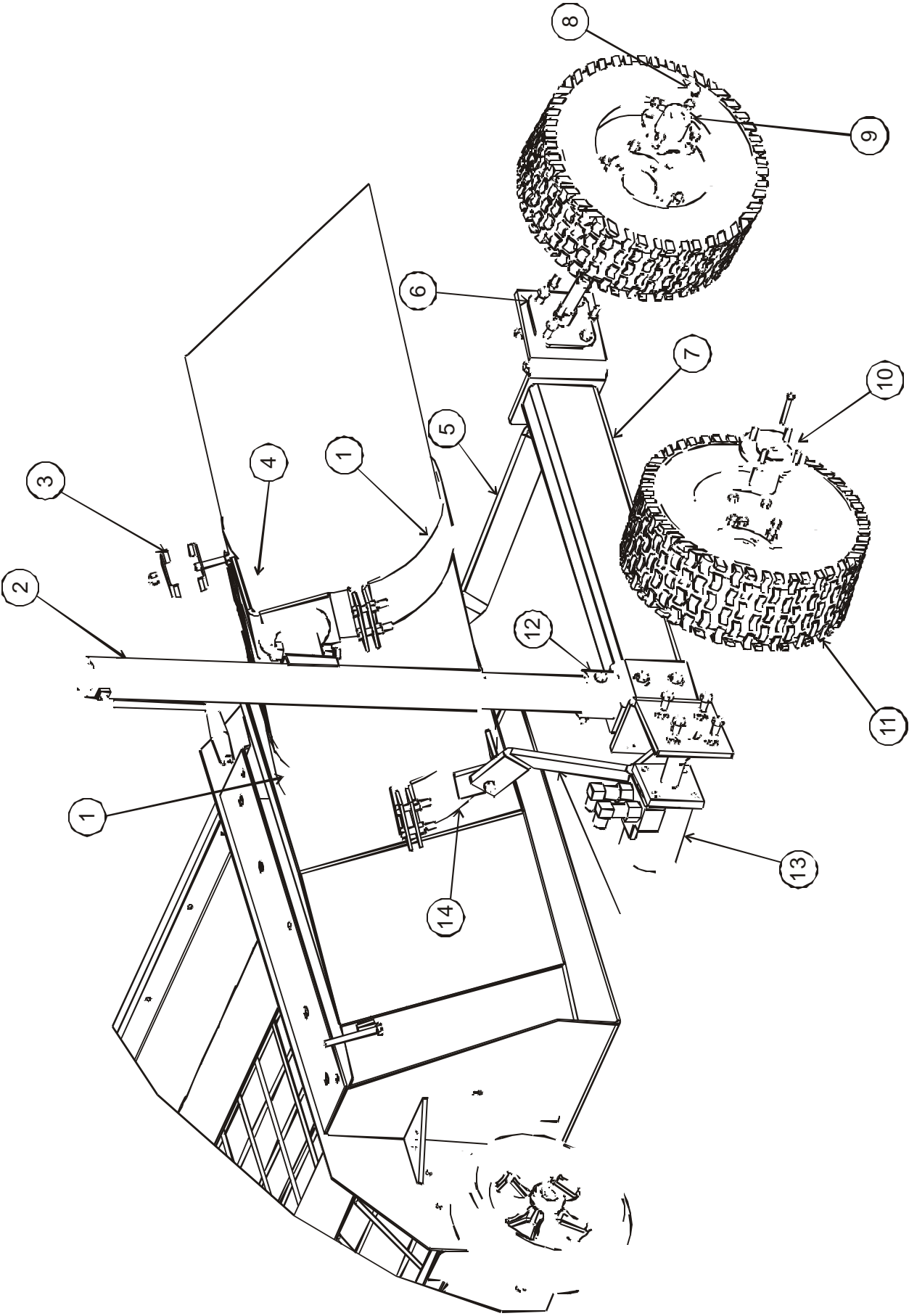

Hydraulic Wheel Kit Parts List		
Item #	Part #	Description
1	GK5117	Halfband: 10" x 4" 7Ga. Painted
	GK4599	Halfband: 12" x 4" 7Ga. Painted
2	GK6536	Motor: 15HP 460/3/60 254T
3	GK6549	Hose Holder
4	GK6639	10" Rear Halfband
	GK6540	12" Rear Halfband
5	GK6535	Angled Support
6	GK6537	Spindle
7	GK6541	Axle w/ Angle Mounts
8	GK6546	Snap Ring
9	GK6545	Hub with Bushings
10	GK6538	Drive Hub Assembly
11	GK6533	Wheel for Hydraulic Wheel Kit
12	GK6542	Lower Jack Mount
13	GK6534	Hydraulic Motor
14	GK6638	10" Front Half Band
	GK6539	12" Front Half Band
15	GK6611	Hydraulic Hose: 1/2" x 7'
16	GK6616	Orifice 1/2" to 1/2" NPT
17	GK6613	1/2" to 1/2" 90 Deg. FTG
18	GK6548	Directional Valve
19	GK6615	Hyd: 3/4" to 1/2" NPT FTG
20	GK6612	Hydraulic Hose: 1/2" x 14'
21	GK6641	10" Hose Holder Band
	GK6551	12" Hose Holder Band
22	GK1057	Halfband: 10" x 2" 12 Ga. Painted
	GK1409	Halfband: 12" x 2" 12 Ga. Painted
23	GK6640	10" Valve Halfband
	GK6550	12" Valve Halfband
24	GK5115	Halfband: 10" x 4" 12 Ga. Painted
	GK2412	Halfband: 12" x 4" 12 Ga. Painted
25	GK6614	Hyd: 3/4" to 1/2" 90 Deg. FTG

Direct Valve and Hydraulic Hose Parts

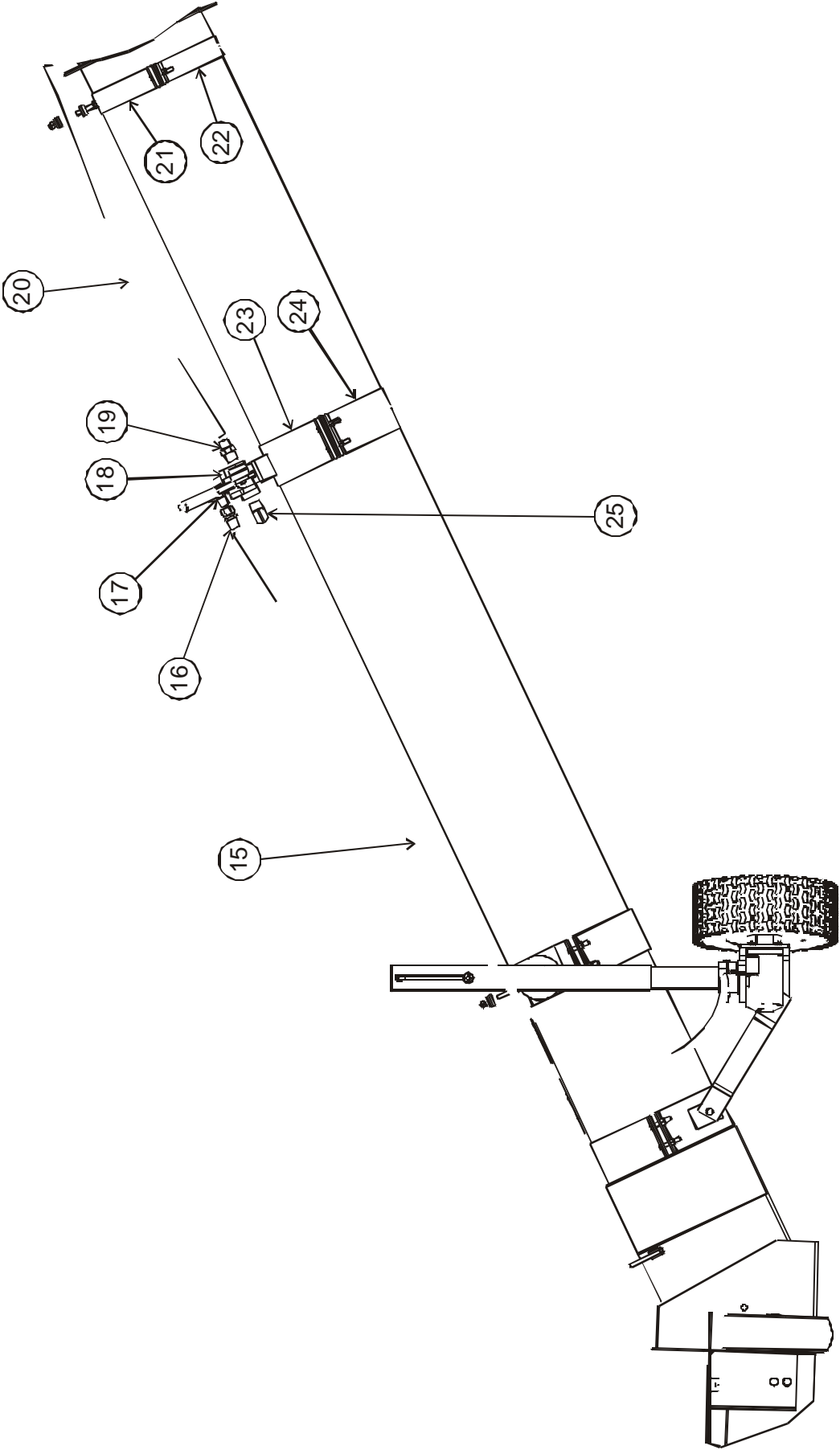

---

---

## **WARRANTY**

THE COMPANY WARRANTS ALL PRODUCTS MANUFACTURED TO BE FREE OF DEFECTS IN MATERIAL AND WORKMANSHIP UNDER NORMAL USAGE AND CONDITIONS FOR A PERIOD OF TWELVE (12) MONTHS AFTER RETAIL SALE TO THE ORIGINAL END USER OF SUCH PRODUCTS. OUR ONLY OBLIGATION IS, AND PURCHASER'S SOLE REMEDY SHALL BE TO REPAIR OR REPLACE, AT THE COMPANY'S OPTION AND EXPENSE, PRODUCTS THAT, IN THE MANUFACTURERS SOLE JUDGEMENT, CONTAIN A MATERIAL DEFECT DUE TO MATERIALS OR WORKMANSHIP. ALL DELIVERY AND SHIPMENT CHARGES TO AND FROM THE FACTORY WILL BE PURCHASER'S RESPONSIBILITY. EXPENSES INCURRED BY OR ON BEHALF OF THE PURCHASER WITHOUT PRIOR WRITTEN AUTHORIZATION FROM AN AUTHORIZED EMPLOYEE OF THE COMPANY SHALL BE THE SOLE RESPONSIBILITY OF THE PURCHASER.

EXCEPT FOR THE ABOVE EXPRESS LIMITED WARRANTIES, THE COMPANY MAKES NO WARRANTY OF ANY KIND, EXPRESSED OR IMPLIED, INCLUDING, WITHOUT LIMITATION, WARRANTIES OF MERCHANTABILITY OR FITNESS FOR A PARTICULAR PURPOSE OR USE IN CONNECTION WITH (i) PRODUCT MANUFACTURED OR SOLD BY THE COMPANY OR (ii) ANY ADVICE, INSTRUCTION, RECOMMENDATION OR SUGGESTION PROVIDED BY AN AGENT, REPRESENTATIVE OR EMPLOYEE OF THE COMPANY REGARDING OR RELATED TO THE CONFIGURATION, INSTALLATION, LAYOUT, SUITABILITY FOR A PARTICULAR PURPOSE, OR DESIGN OF SUCH PRODUCT OR PRODUCTS.

IN NO EVENT SHALL THE COMPANY BE LIABLE FOR ANY DIRECT, INDIRECT, INCIDENTAL, OR CONSEQUENTIAL DAMAGES, INCLUDING, WITHOUT LIMITATION, LOSS OF ANTICIPATED PROFITS OR BENEFITS. PURCHASER'S SOLE AND EXCLUSIVE REMEDY SHALL BE LIMITED TO THAT STATED ABOVE, WHICH SHALL NOT EXCEED THE AMOUNT PAID FOR THE PRODUCT PURCHASED. THIS WARRANTY IS NOT TRANSFERABLE AND APPLIES ONLY TO THE ORIGINAL PURCHASER. WE SHALL HAVE NO OBLIGATION OR RESPONSIBILITY FOR ANY REPRESENTATIVE OR WARRANTIES MADE BY OR ON BEHALF OF ANY DEALER, AGENT OR DISTRIBUTOR OF THE COMPANY.

THE COMPANY ASSUMES NO RESPONSIBILITY FOR FIELD MODIFICATIONS. MODIFICATIONS TO THE PRODUCT NOT SPECIFICALLY COVERED BY THE CONTENTS OF THIS MANUAL WILL NULLIFY ANY PRODUCT WARRANTY THAT MIGHT HAVE BEEN OTHERWISE AVAILABLE. THE USE OF OUR EQUIPMENT TO HANDLE MATERIALS OTHER THAN FREE FLOWING, NONABRASIVE AND DRY MATERIALS, AS INTENDED, WILL RESULT IN THE VOIDING OF THIS LIMITED WARRANTY.

THE FOREGOING WARRANTY SHALL NOT COVER PRODUCTS OR PARTS WHICH HAVE BEEN DAMAGED BY NEGLIGENT USE, MISUSE, ALTERATION, OR ACCIDENT. ANY NEGLIGENT USE, MISUSE, ALTERATION, OR DAMAGE DUE TO ACCIDENT, AS DETERMINED BY A COMPANY REPRESENTATIVE, MAY VOID THE WARRANTY. THIS WARRANTY COVERS ONLY PRODUCTS MANUFACTURED BY THE COMPANY. THIS WARRANTY IS EXCLUSIVE AND IN LIEU OF ALL OTHER WARRANTIES EXPRESS OR IMPLIED. WE RESERVES THE RIGHT TO MAKE DESIGN OR SPECIFICATION CHANGES AT ANY TIME, BEARING NO RESPONSIBILITY TO MAKE SIMILAR DESIGN OR SPECIFICATION CHANGES ON PREVIOUSLY SOLD MERCHANDISE.

PRIOR TO INSTALLATION, PURCHASER HAS THE RESPONSIBILITY TO RESEARCH AND COMPLY WITH ALL FEDERAL, STATE, AND LOCAL CODES WHICH MAY APPLY TO THE LOCATION AND INSTALLATION.

---

---

**This Equipment shall be installed in accordance with the current installation codes and applicable regulations which should be carefully followed in all cases. Authorities having jurisdiction should be consulted before installation occurs.**



1004 East Illinois Street  
Assumption, IL 62510  
217-226-4421 Phone

---

---