

6" & 8" Bin Sweep Auger Wheel Assembly Instructions

1. Assemble the 6" and 8" Bin Sweep Auger Wheel.

- A. Install the **Roll Pin** in the **Shaft of Stub** so that it is centered in the **Shaft of Stub** with the same amount of pin sticking out on each side.
- B. Place two (2) **Steel Discs** on the **Shaft of Stub** against the **Roll Pin**.
- C. Place all five (5) **Rubber Discs** on the **Shaft of Stub**.
- D. Place two (2) more **Steel Discs** on the **Shaft of Stub**.
- E. Place the **Lockwasher** against the **Steel Discs**.
- F. Secure the **Nut** tightly on the **Shaft of Stub** to complete the assembly.

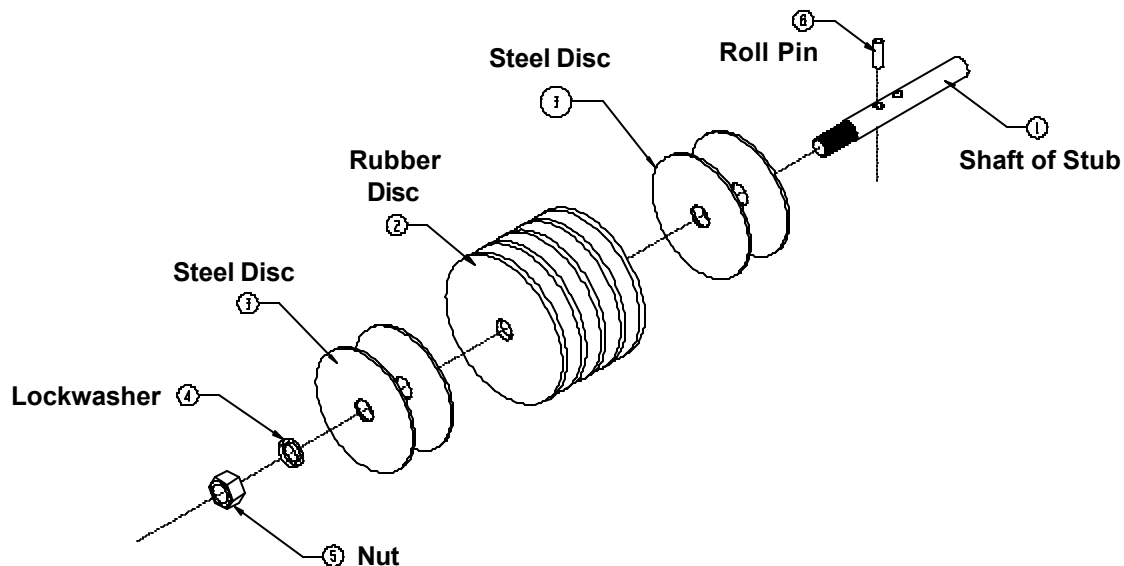

Ref. #	Part #	Description	Qty.
1	GK1077	Sweep Wheel Stub	1
2	GK1238	5" (12.70 cm) OD Rubber Disc Wheel for the 6" Bin Sweep Auger	5
2	GK1067	6" (15.24 cm) OD Rubber Disc Wheel for the 8" Bin Sweep Auger	5
3	GK1232	4" (10.16 cm) OD Steel Wheel Disc for the 6" Bin Sweep Auger	4
3	GK1076	5" (12.70 cm) OD Steel Wheel Disc for the 8" Bin Sweep Auger	4
4	S-233	Lockwasher	1
5	S-234	Hex Nut	1
6	S-4377	Roll Pin - 5/16" x 2" (5.08 cm) long	1