

16" HOPPER BELT ASSEMBLY FOR BOLT-ON HOPPER

Fasten the belt to the hopper sides and front (or Back) with six(6) straps and twelve 1/4" x 3/4" (grade 5) bolts and locknuts.

Fasten the back support strap (N/S) to the belt with six(6) 1/4" x 3/4" (grade 5) bolts, flatwashers and locknuts.

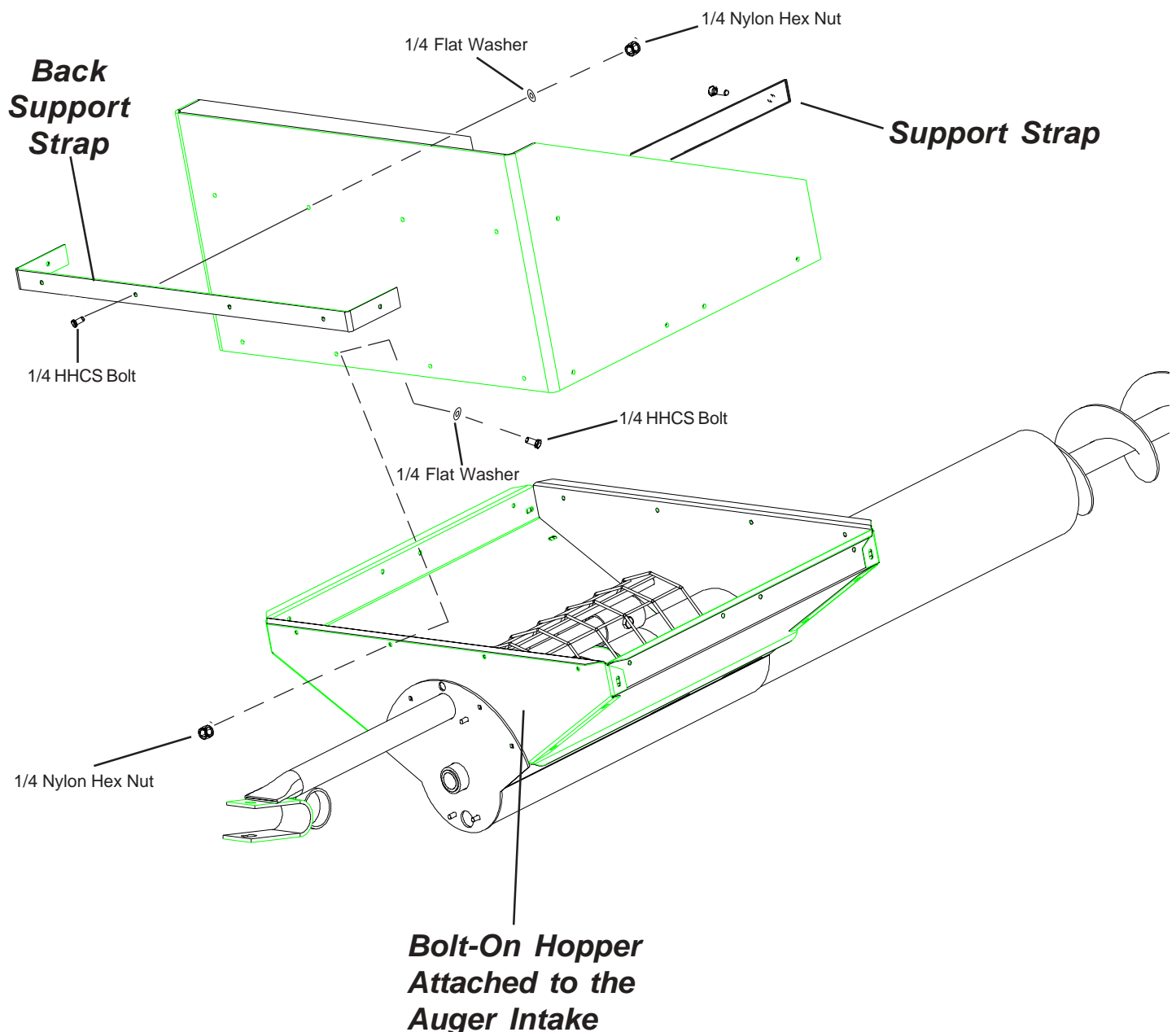

Pneg-871